

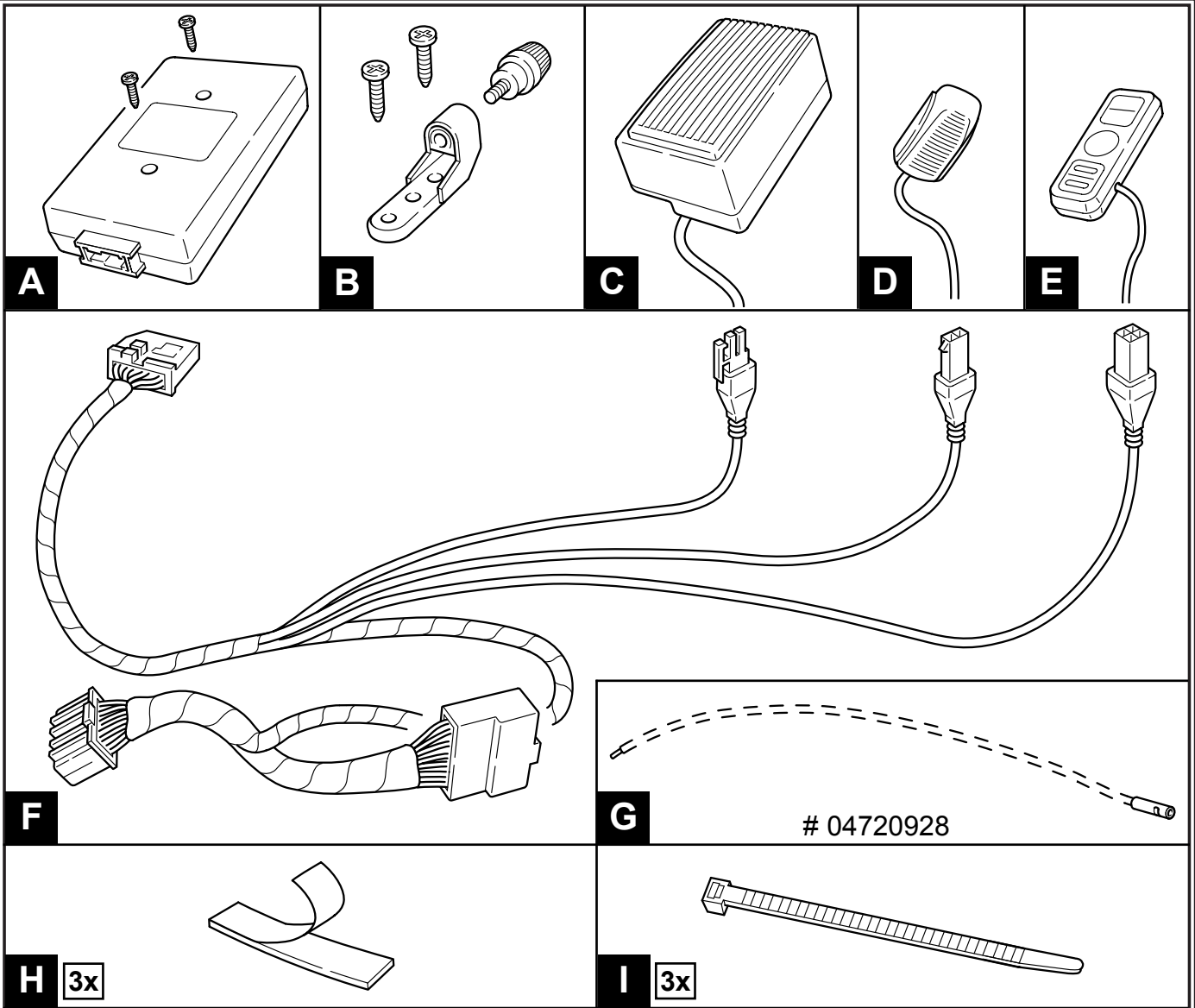

MOPAR®

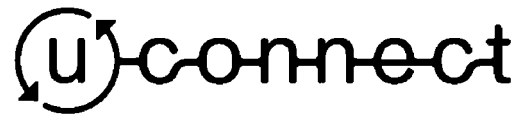

CHRYSLER	DODGE	JEEP
PT CRUISER 6	MAGNUM 11,12	LIBERTY 18
300M 7	NEON 13	GRAND CHEROKEE . . . 19
CONCORDE 7	INTREPID 7	
SEBRING SEDAN 8	STRATUS 8	
TOWN & COUNTRY 9	CARAVAN 9	
PACIFICA 10	DURANGO/DAKOTA . . . 14	
300C 11,12	2004 DURANGO . . . 15,16	
	RAM 17	

IMPORTANT NOTES

GB

- Disconnect and isolate negative battery cable.
- Disconnect and remove overhead console or dome lamp, if equipped.
- Remove left (driver's side) A-pillar trim panel and left I/P access panel.
- Remove I/P center cluster bezel. Disconnect and remove radio.
- Remove knee blocker panel(s).
- Install kit components as described in notes and as shown in illustrations. Ensure that all vehicle mounting surfaces are clean.
- Route Item F 22-way connectors and Item E cable connector up into the I/P at the knee blocker opening, and out of the radio opening. Keep away from sharp edges, heat sources, or moving parts.
- **2002-2004 Vehicles:** Plug Item F 22-way connectors into radio and radio connector.
- **1990-2001 Vehicles:** Follow procedure shown on page 5. Securely crimp a ground eyelet or a blade terminal to the black wire.
- Make electrical connections to items A, C, D, and E.
- Loop-up slack in harness and cables. Apply tie straps and stow away neatly. Do not kink or tightly coil the cables.
- Re-install vehicle components and trim panels, ensuring that cables are not pinched under them.
- Perform a functional check of the system by following the steps shown on page 20 of this document.

ITEM A:

Place supplied 2-way tape to underside of module. Ensure tape contacts to vehicle mounting surfaces. Install tie straps and mounting screws if needed.

ITEM B:

Measure for bracket mounting holes as shown in illustrations. Using the bracket as a template, drill two 1/8" holes. Install bracket with supplied screws.

ITEM C:

Install speaker to mounting bracket. Position speaker as shown in illustrations. Tighten thumb screw with flat blade screwdriver (do not overtighten).

ITEM D:

Remove backing from 2-way tape at underside of microphone. Install mic to overhead console or dome lamp if equipped. Using a small circular file, make a notch in the console/dome lamp bezel edge closest to the mic. Route mic cable under headliner towards left A-pillar.

ITEM E:

Secure control pad cable inside trough at the back of the unit. Remove backing from 2-way tape at underside of control pad. Install control pad to I/P center console bezel using a small circular file, make a notch in the inner edge of the radio or HVAC opening closest to the control pad.

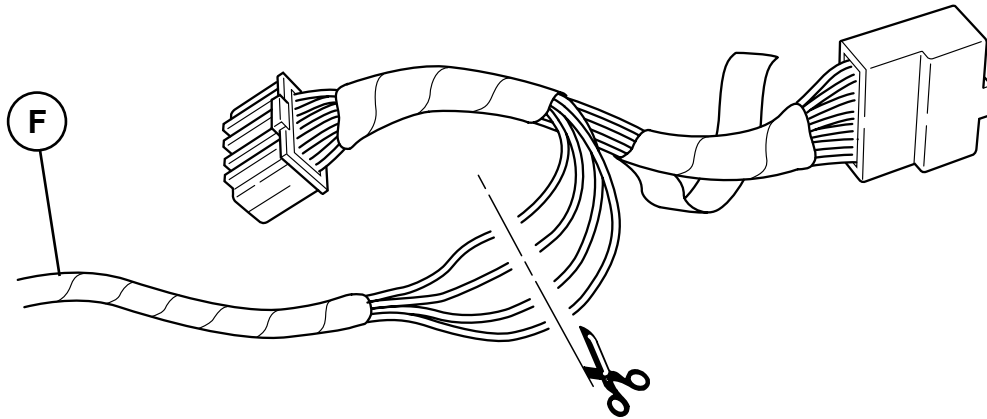

1

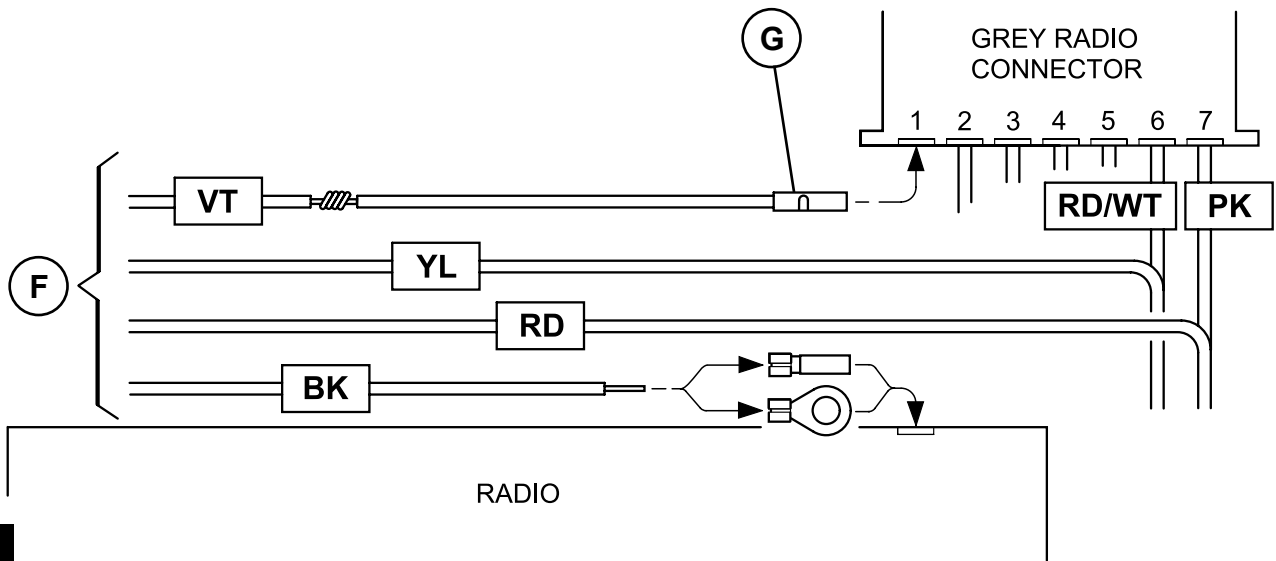

2

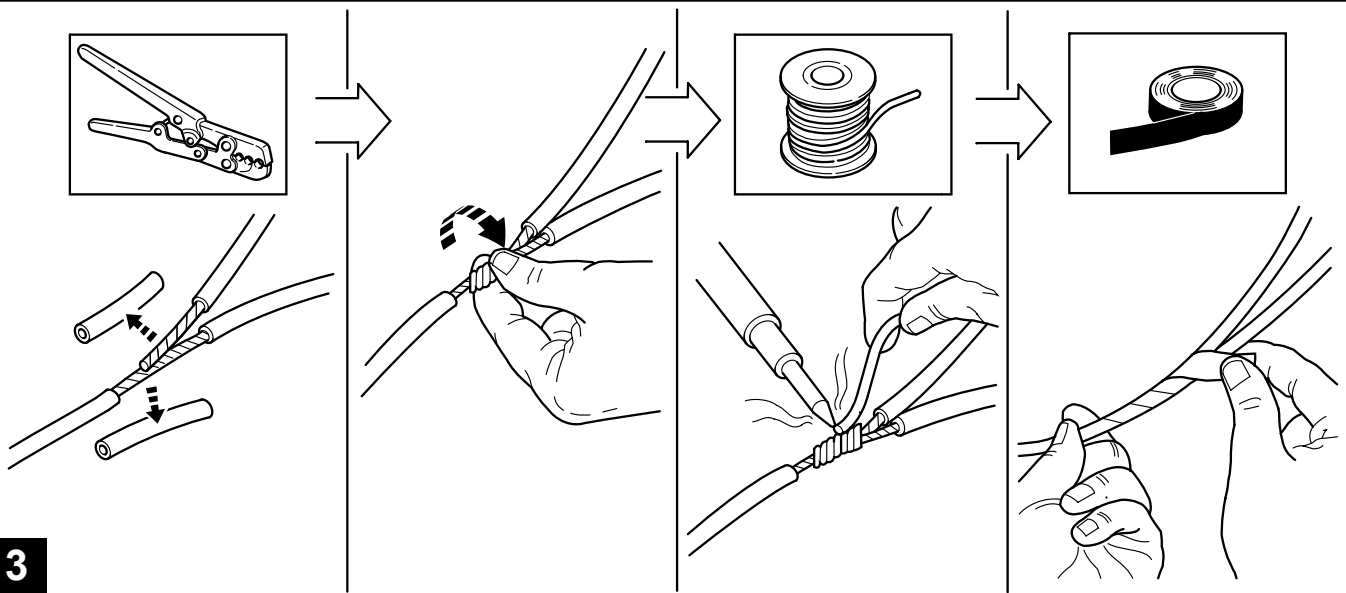

3

JEEP GRAND CHEROKEE

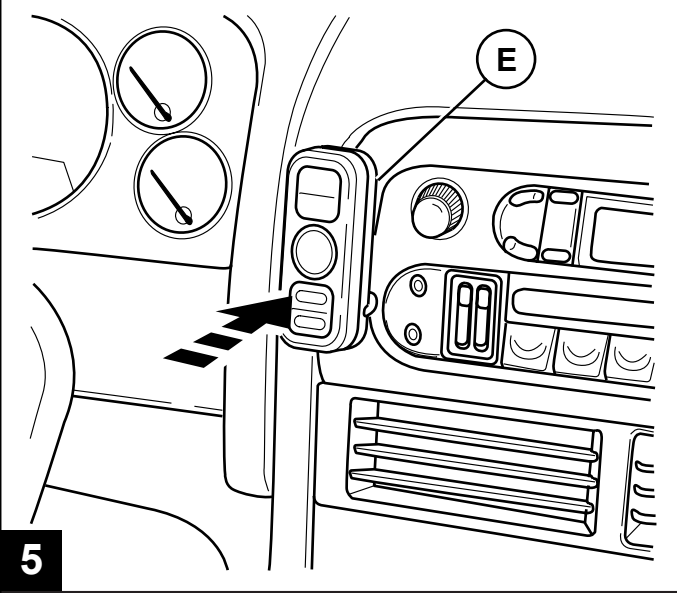
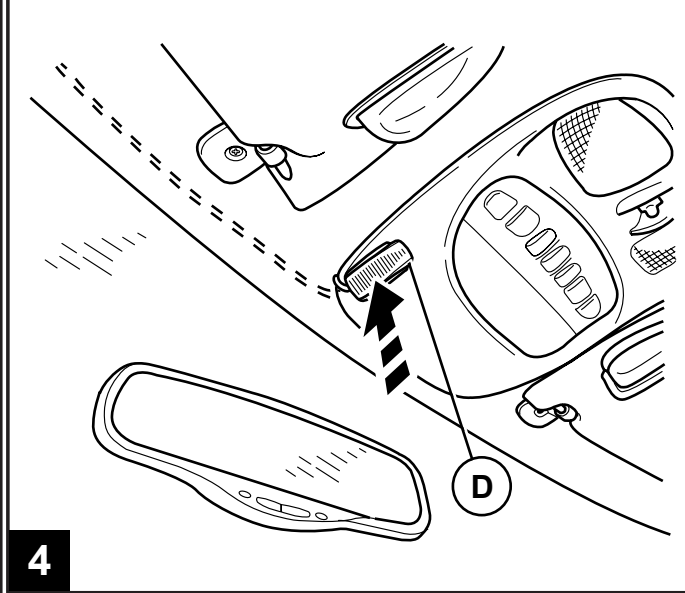
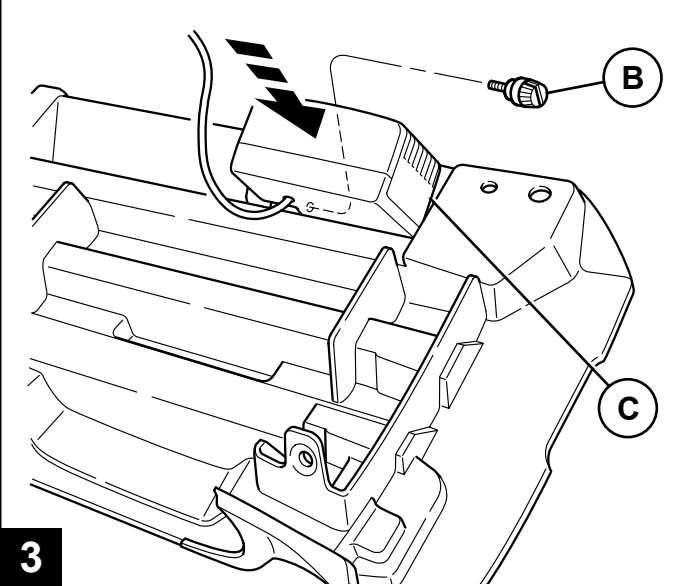
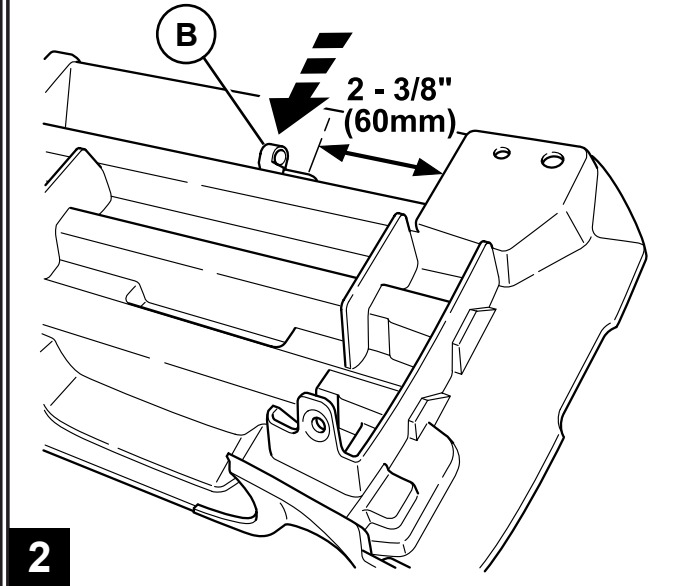
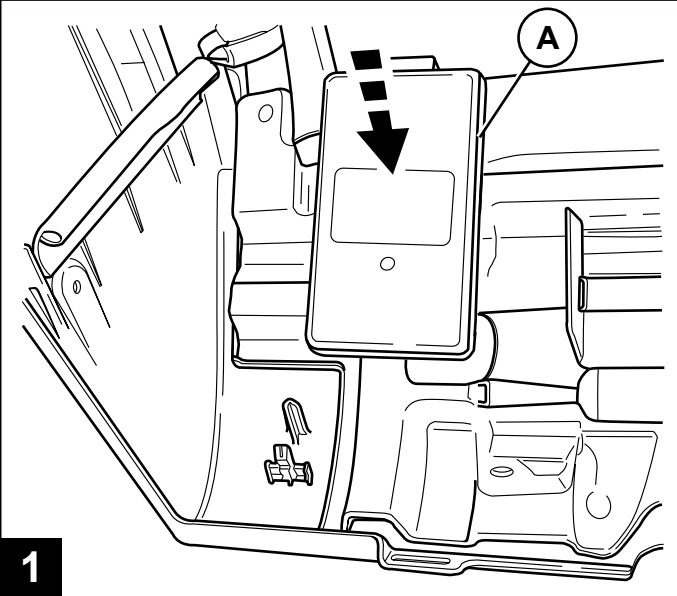
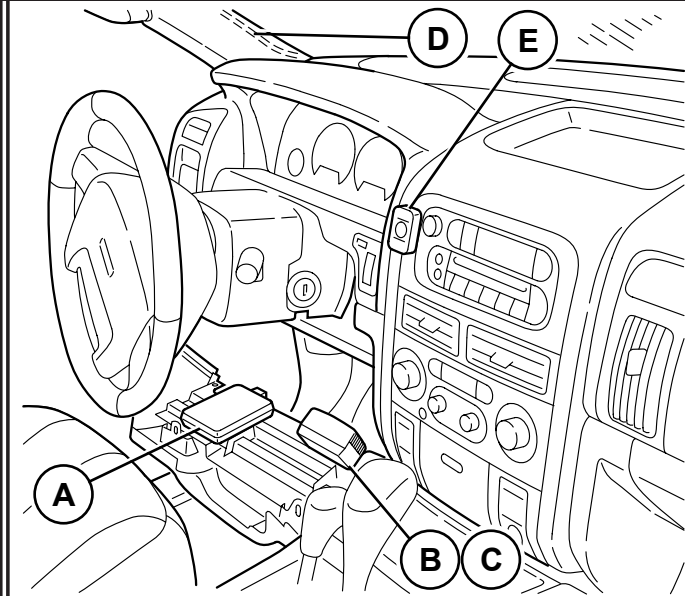

GB FUNCTIONAL CHECK PROCEDURE

1. Turn Ignition key to On position and turn radio on
 - Both amber light indicators on the UConnect control pad will illuminate momentarily (approx. 3 seconds)
2. Press UConnect Button on the control pad
 - System prompt will announce "UConnect Ready"
 - Radio audio will mute
 - Say "Dial", system should reply "Phone Not Available"
3. Push UConnect button again
 - System prompts with a dual tone beep
 - Radio will return to preset volume

Please follow included Owner's Manual for system operation.

E PROCEDIMIENTO DE VERIFICACIÓN FUNCIONAL

1. Gire la llave de Encendido hacia la posición ON y encienda el radio.
 - Ambos indicadores de luz color ámbar en el cojín de control UConnect se encenderán por un momento (3 segundos, aprox.)
2. Presione el botón UConnect en el cojín de control
 - Un aviso del sistema anunciará "UConnect Ready" (UConnect Listo)
 - El radio quedará en silencio
 - Diga "Dial" (Marcar). El sistema debe responder "Phone Not Available" (Teléfono no disponible).
3. Presione el botón UConnect nuevamente
 - SEI sistema responderá con un sonido de dos tonos
 - El volumen del radio regresará a su valor preestablecido

Para operar el sistema, siga las instrucciones que parecen en el Manual del Propietario.

F VÉRIFICATION DU FONCTIONNEMENT

1. Mettre le contact et allumer la radio
 - Les deux témoins jaunes du pavé de commande Uconnect s'allument brièvement (environ 3 secondes)
2. Appuyer sur le bouton Uconnect du pavé de commande
 - Un message vocal annonce << Uconnect Ready >>
 - La radio se met en sourdine
 - Dire : << Dial >>, le système doit répondre << Phone Not Available >>
3. Appuyer de nouveau sur le bouton UConnect
 - Le système produit un bip à double tonalité
 - La radio repasse au volume pré réglé.

Voir les instructions d'utilisation dans le manuel de l'appareil.